

DELIVERING GLOBAL EXCELLENCE



*The Art of Vending*



**Vendo**  
SANDEN







COMPANY PROFILE.....	<b>4</b>
G-CAFFÈ.....	<b>8</b>
MODULAR SYSTEM.....	<b>10</b>
VERTICAL RAIL SYSTEM.....	<b>12</b>
G-DRINK.....	<b>14</b>
G-SNACK.....	<b>22</b>
SANDENVENDO ECO-PROJECT.....	<b>34</b>
WHY CO <sub>2</sub> ?.....	<b>36</b>
BOTTLE AND CAN (B&C).....	<b>38</b>
G-FROZEN.....	<b>44</b>
COIN CHANGER.....	<b>46</b>

# COMPANY PROFILE

**SANDENVENDO** IN EUROPE HAS BEEN ADVANCING THE VENDING INDUSTRY FOR MANY DECADES AND IS A POWERFUL PARTNER FOR EXCELLENCE IN QUALITY, RELIABILITY AND SERVICE.

WE ARE A "ONE-STOP-SHOP SUPPLIER", OFFERING A WIDE VARIETY OF VENDING EQUIPMENT FOR HOT AND COLD BEVERAGES, SNACKS AND ICE CREAM.

BUT ALSO RELATED PRODUCTS SUCH AS SOPHISTICATED PAYMENT SYSTEMS AND PREMIUM COOLERS.

ORIGINALLY BASED IN DALLAS, TEXAS, USA, SANDENVENDO CONTINUES TO DELIVER THE HIGHEST STANDARD PRODUCT DIVERSITY SINCE THE BEGINNING OF IT'S OPERATIONS OVER 80 YEARS AGO.

AS PART OF THE JAPANESE SANDEN CORPORATION SINCE 1988, SANDENVENDO IS YOUR GLOBAL PARTNER IN VENDING AND COOLING TECHNOLOGY, BACKED BY NUMEROUS PRODUCTION AND SERVICE FACILITIES AROUND THE WORLD.

## GLOBAL MARKET SHARE OF SANDEN GROUP

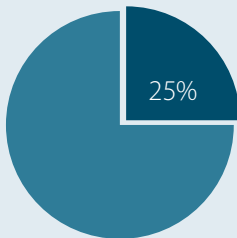

AUTOMOTIVE

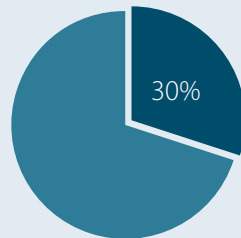

VENDING

*SANDEN, global specialist in heating and cooling technologies, are recognized as one of the leading companies in thermodynamics both in the automotive industry and mobile appliances such as food refrigeration. Sanden, with its 54 locations in 23 countries, develops and produces vending machines, refrigerated showcases and compressors for mobile air conditioning systems.*



...DELIVERING GLOBAL EXCELLENCE

# HISTORY



# GLOBAL SANDEN GROUP

**54** LOCATIONS IN **23** NATIONS

TOTAL EMPLOYEES : **15,000** PEOPLE (CONSOLIDATED)





# A GLOBAL SYNERGY



## MANUFACTURING STRUCTURE

### SANDEN CORPORATION

SANDEN FOREST AKAGI PLANT (AP)	SANDENVENDO AMERICA INC. (SVA)	SANDENVENDO EUROPE S.P.A. (SVE)	SANDEN INTERCOOL THAILAND (SIC)	SANDEN SHANGHAI REFRIGERATION (SSR)
---	---	--	--	--

## SANDENVENDO STRUCTURE

AUTOMOTIVE



LIVING ENVIRONMENT

### SANDEN CORPORATION (SDC) FOOD AND BEVERAGE SERVICE (VENDING)

<b>SANDENVENDO AMERICA INC. (SVA)</b> PRODUCTION, SALES & SERVICE		<b>SANDEN INTERNATIONAL (EUROPE) LTD</b> HEADQUARTER SALES & SERVICE		
<b>SANDENVENDO AMERICA INC. (SVA)</b> DALLAS, TEXAS, USA	PRODUCTION, SALES & SERVICE	<b>SANDEN INT'L (EUROPE) LTD</b> SANDENVENDO GERMAN BRANCH	SALES & SERVICE GERMANY EXPORT SALES	
		<b>SANDEN INT'L (EUROPE) LTD</b> SANDENVENDO ITALIAN BRANCH	SALES & SERVICE ITALY	
		<b>SANDENVENDO EUROPE S.P.A. (SVE)</b>	PRODUCTION (CASALE, ITALY)	
		<b>SANDEN INT'L (EUROPE) LTD</b> SANDENVENDO BENELUX	SALES & SERVICE BENELUX	
		<b>SANDEN INT'L (EUROPE) LTD</b> SANDENVENDO FRANCE	SALES & SERVICE FRANCE	
		<b>SANDEN INT'L (EUROPE) LTD</b> SANDENVENDO SPAIN, SUCURSAL EN ESPANA	SALES & SERVICE SPAIN & PORTUGAL	



G-Caffè Design FS700

G-Caffè  FS Espresso Italy

# Easy, Friendly, Healthy.

NO BRASS ON BOARD. Water circuit 100% heavy metal free.

A new emotion.

Something to make you feel warm from the inside.

SandenVendo presents **G-Caffè**, the first Espresso Coffee Machine developed in a total fusion of Japanese technology and Italian craftsmanship.

The first ever automatic 1000 cup vending machine presented by SandenVendo: User friendly, with easy maintenance including the Vendo "all-in-one-site drawer".

A professional coffee brewer and grinder, high capacity double column stirrers dispenser and an innovative capacitive key pad.

MODEL	ESPRESSO SINGLE BOILER ES 7	ESPRESSO DOUBLE BOILER ED 7	INSTANT IN 7
DIMENSIONS H x W x D (mm)	1830 x 650 x 770	1830 x 650 x 770	1830 x 650 x 770
WEIGHT (NET - Standard machine without options)	180 kg	180 kg	180 kg
CUPS	Up to 1000	Up to 1000	Up to 1000
CUP TYPES	70-73 mm or 80 mm	70-73 mm or 80 mm	70-73 mm or 80 mm
STIRRER	1000 pcs (600 pcs for single column)	1000 pcs (600 pcs for single column)	1000 pcs (600 pcs for single column)
NO. OF SELECTIONS	22	22	22
PRE-SELECTION	1	1	1
DISPLAY	VFD (Vacuum fluorescent graphic display) - display size 115 x 29 mm	VFD (Vacuum fluorescent graphic display) - display size 115 x 29 mm	VFD (Vacuum fluorescent graphic display) - display size 115 x 29 mm
WATER FITTING CONNECTION	G 3/4" 2-8 bar	G 3/4" 2-8 bar	G 3/4" 2-8 bar
PROTOCOL	MDB / Executive	MDB / Executive	MDB / Executive
POWER SUPPLY	230 V / 50 Hz	230 V / 50 Hz	230 V / 50 Hz
MAX. POWER CONSUMPTION	1800 W	2500 W	2500 W

MAIN COMPONENTS	QUANTITY	CAPACITY
COFFEE BEANS CONTAINER	1	4.9 kg (single) - 5.1 kg (double)
GRINDER	1	Professional Conic blade
BOILER (stainless steel)	1	500 ml
SUGAR CONTAINER IN CUP	1	5.8 l - 5 kg
INGREDIENT CONTAINER	Max 6 (M size) Max 8 (S size)	CONTAINER SIZE: Small: 2.8 l - Medium: 4.4 l - Large: 5.8 l

PRODUCT CAPACITY	CANISTER SIZE		
	SMALL	MEDIUM	LARGE
SUGAR	2,3 kg	3,8 kg	5,0 kg
POWDER MILK	0,9 kg	1,4 kg	1,8 kg
CHOCOLATE	2,0 kg	3,3 kg	4,3 kg
LEMON TEA	2,6 kg	4,4 kg	5,7 kg
GINSENG COFFEE	1,3 kg	2,2 kg	3,3 kg
DECAF. COFFEE	1,3 kg	2,2 kg	3,3 kg
INSTANT COFFEE	1,3 kg	2,2 kg	3,3 kg
BARLEY COFFEE	0,6 kg	0,4 kg	1,3 kg



### INNOVATION

- ▶ COFFEE CONTAINER FLEX SYSTEM
- ▶ LARGE VFD (VACUUM FLUORESCENT GRAPHIC DISPLAY)
- ▶ AUTOMATIC GRINDING (OPTIONAL)
- ▶ VARIABLE SPEED MIXERS
- ▶ VARIABLE SPEED INGREDIENT MOTORS
- ▶ VARIABLE FLOW RATE PUMPS FOR INSTANT PRODUCT (HOT WATER TANK VERSION)
- ▶ 3 SIZE OF INGREDIENT CONTAINERS
- ▶ INNOVATIVE STIRRER AND SUGAR DISPENSER (PATENT PENDING)
- ▶ QUICK FIT PLASTIC VALVES



### USER INTERFACE

- ▶ LED DOOR PANEL ILLUMINATION
- ▶ CAPACITIVE TOUCH PAD
- ▶ ERGONOMIC DESIGN FOR CHILDREN AND WHEEL CHAIR USERS
- ▶ FLEXIBLE CUP DISPENSER AVAILABLE AS STANDARD 70-73 mm (OPTION 80 mm)
- ▶ CAPACITY TO ACCOMMODATE UP TO 3 PAYMENT SYSTEM TOGETHER
- ▶ ADVANCED 32 BIT ELECTRONICS WITH FLASH MEMORY
- ▶ MASTER - SLAVE CONNECTIONS WITH G-SNACK SLAVE MACHINE



### OPTION LIST

- ▶ SPECIAL CODED LOCK (RIELDA)
- ▶ CUP SENSOR
- ▶ DEX / UCS KIT
- ▶ TELEMETRY KIT
- ▶ 80 mm CUP DISPENSER
- ▶ EXTERNAL WATER TANK KIT (20 l)
- ▶ VALIDATOR KIT
- ▶ MEMORY KEY
- ▶ KIT EVA DTS
- ▶ WATER SOFTNER (FILTER)
- ▶ DOUBLE GRINDER
- ▶ CUSTOMIZED CABINET COLOUR
- ▶ NUTRITION DISPLAY



### MAINTENANCE

- ▶ SW UPDATE THROUGH USB
- ▶ EASY REGULAR MAINTENANCE VIA 8 FUNCTION KEYS
- ▶ EASY PULL OUT DRAWER FOR QUICK MAINTENANCE
- ▶ HIGH VOLTAGE SOLID STATE RELAY FOR SINGLE LOAD
- ▶ 24VDC DEVICES (EXCEPT HEATER, GRINDER, PUMP)

### STANDARD CABINET COLOUR



Black



# Modular System

For solving the problem  
of narrow passages

The Modular **G-Snack** & **G-Drink** DESIGN is developed to overcome the hassle of a narrow doorway.



**QUICK AND EASY INSTALLATION**

The mechanical part of the unit can be easily separated from the electronic one: this reduces the main cabinet by 20 cm!!

**Modular system is available for the following models of G-Drink and G-Snack lines:**



**G-Drink**  
DC 6



**G-Drink**  
DC 6 OD



**G-Drink**  
DM 6



**G-Drink**  
DM 6 OD



**G-Snack**  
SC 6



**G-Snack**  
SC 6 OD



**G-Snack**  
SC 8



**G-Snack**  
SC 8 OD



**G-Snack**  
SM 6



**G-Snack**  
SM 6 OD



**G-Snack**  
SM 8



**G-Snack**  
SM 8 OD

# Vertical-rail system

## Reducing Service Calls

### **Best-in-class Glass Front Vendor: G-Drink.**

The success of this machine is a very simple but an extremely reliable delivery mechanism.

This mechanism, a robot, is developed in Japan with a cutting-edge technology calculating meticulously all mechanical movements before taking the product with the catcher and delivering it in the most accurate way possible.

Should a product accidentally drop down, the new vertical lift system allows the catcher to slide over the bottle without hindering its movement.

The chosen product will thus be delivered meaning you won't be missing out on sales. Moreover, service calls are reduced to the absolute minimum ensuring you from the highest benefit.

The new vertical lift system will contribute even more to your succes!



G-Drink VERTICAL  
is available for G-Drink  
and G-Drink DESIGN line



G-Drink Design  
Vertical  
DV 9



G-Drink Design  
Vertical  
DV 6



G-Drink  
Vertical  
DM 9



G-Drink  
Vertical  
DM 6



— Design Line —



G-Drink Design 9  
Vertical

## G-Drink Design **Hydro-lution**

### THE BEST FEATURES

The evolution of **G-Drink** never ends.

The most successful Glass Front Vendor of our history presented in a new look.

A spacious and brightly illuminated showcase enhances the product visibility.

An innovative capacitive key pad with back lit numerals provide high visibility in light and dark places. New user friendly features offer a large display in blue characters with a new easy door latching system.







MODEL	G-DRINK DESIGN 9 VERTICAL DV 9	G-DRINK DESIGN 6 VERTICAL DC 6
DIMENSIONS H x W x D (mm)	1830* x 1215 x 845	1830* x 940 x 845
WEIGHT (NET - Standard machine without options)	345 kg	295 kg
NO. OF SELECTIONS PER SHELF	9	6
NO. OF SHELVES	Standard 5 / Max. 7	Standard 5 / Max. 7
NO. OF SELECTIONS	Standard 45 / Max. 63	Standard 30 / Max. 42
MAX. CAPACITY (0,33 l CANS)	504	336
MAX. CAPACITY (0,50 l PET BOTTLES)	360	240
PROTOCOL	Executive / MDB	Executive / MDB
COOLING SYSTEM CONTROL	Electronic	Electronic
INTERNAL TEMPERATURE RANGE	+2°C up to +10°C	+2°C up to +10°C
MAX. POWER CONSUMPTION	800 W	800 W
POWER SUPPLY	230 V / 50 Hz	230 V / 50 Hz
CLIMATE CLASS	ST (+16°C up to +38°C)	ST (+16°C up to +38°C)
ENERGY CONSUMPTION **	238 wh/h	252 wh/h
ENERGY CLASS **	A++	A

\* With adjustable leveling screw \*\* According to EVA EMP 3.0 - Data available upon request



### OPTION LIST

- ▶ CUSTOMIZED CABINET COLOUR
- ▶ SPECIAL CODED LOCK (RIELDA)
- ▶ ANTI-VANDALISM KEY PAD AND SAFETY COIN INSERT
- ▶ WALL/FLOOR FIXING KIT
- ▶ BRANDING
- ▶ PRODUCT SPACERS
- ▶ VARIOUS FITTING KITS
- ▶ LOCK PROTECTION
- ▶ FRONT GLASS PROTECTION
- ▶ CO<sub>2</sub> COOLING UNIT AVAILABLE



### VENDABLE PRODUCT SIZE

#### ▶ PET BOTTLES, GLASS BOTTLES, CANS

DIAMETER	min. 43.5 mm	max. 71.5 mm
HEIGHT	min. 88 mm	max. 266 mm
WEIGHT	min. 185 g	max. 653 g

#### ▶ CARTON PACKS (BRICK)

WIDTH	min. 52 mm	max. 67 mm
DEPTH	min. 40 mm	max. 47 mm
HEIGHT	min. 85 mm	max. 134 mm
WEIGHT	min. 213 g	max. 400 g

Please note: The above dimensions are for reference only.  
Some products, although within the above dimensions, may be difficult to vend due to its shape.  
Please vend test products before filling machine.



LED LIGHT



LED illumination as standard. Cold tone with an ideal brightness to boost the product display.

### STANDARD CABINET COLOUR



Black



High reliability and a state-of-art product delivery, designed in Japan.

Removable beverage trays without electrical connection.

Product delivery always in up-right position.



Complete "Design line"



— Design Outdoor —



G-Drink Design 9  
Vertical Outdoor

## G-Drink Design Outdoor

# Outdoor Refreshment

TAKE YOUR BUSINESS OUTDOORS

High reliability is achieved through extreme simplicity in use and maintenance.

Now SandenVendo offers OUTDOOR versions of the most popular model **G-Drink**.

Weather resistance and anti-vandalism fittings can expand your business to OUTDOOR locations!



MODEL	G-DRINK DESIGN 9 VERTICAL OUTDOOR DV 9 OD	G-DRINK DESIGN 6 VERTICAL OUTDOOR DC 6 OD
DIMENSIONS H x W x D (mm)	1875* x 1260 x 1010	1875* x 990 x 1010
WEIGHT (NET - Standard machine without options)	410 kg	350 kg
NO. OF SELECTIONS PER SHELF	9	6
NO. OF SHELVES	Standard 5 / Max. 7	Standard 5 / Max. 7
NO. OF SELECTIONS	Standard 45 / Max. 63	Standard 30 / Max. 42
MAX. CAPACITY (0,33 l CANS)	504	336
MAX. CAPACITY (0,50 l PET BOTTLES)	360	240
PROTOCOL	Executive / MDB	Executive / MDB
COOLING SYSTEM CONTROL	Electronic	Electronic
INTERNAL TEMPERATURE RANGE	+2°C up to +10°C	+2°C up to +10°C
AMBIENT TEMPERATURE RANGE	-15°C up to +32°C	-15°C up to +32°C
MAX. POWER CONSUMPTION	800 W	800 W
POWER SUPPLY	230 V / 50 Hz	230 V / 50 Hz

\* With adjustable leveling screw



### OUTDOOR FEATURES

- ▶ FRONT GLASS PROTECTION
- ▶ ROOF
- ▶ THERMAL MAGNETIC CIRCUIT BREAKER
- ▶ TEMPERATURE CONTROLLER FOR OUTDOOR
- ▶ COOLING UNIT WITH HEATER ANTI-FREEZE FUNCTION (WORKS ALSO OUTSIDE TEMPERATURE BELOW ZERO)
- ▶ WATERPROOF IP34
- ▶ ANTI-VANDALISM (COIN INSERT, KEY PAD AND COIN-RETURN)
- ▶ HEATED GLASS ANTI-CONDENSATION
- ▶ AN EXCELLENT LED ILLUMINATION ALSO IN DARK



### VENDABLE PRODUCT SIZE

#### ▶ PET BOTTLES, GLASS BOTTLES, CANS

DIAMETER	min. 43.5 mm	max. 71.5 mm
HEIGHT	min. 88 mm	max. 266 mm
WEIGHT	min. 185 g	max. 653 g

#### ▶ CARTON PACKS (BRICK)

WIDTH	min. 52 mm	max. 67 mm
DEPTH	min. 40 mm	max. 47 mm
HEIGHT	min. 85 mm	max. 134 mm
WEIGHT	min. 213 g	max. 400 g

Please note: The above dimensions are for reference only.  
Some products, although within the above dimensions, may be difficult to vend due to its shape.  
Please vend test products before filling machine.



### OPTION LIST

- ▶ CUSTOMIZED CABINET COLOUR
- ▶ SPECIAL CODED LOCK (RIELDA)
- ▶ BRANDING
- ▶ PRODUCT SPACERS
- ▶ VARIOUS FITTING KITS
- ▶ WALL / FLOOR FIXING KIT
- ▶ LOCK PROTECTION
- ▶ CO<sub>2</sub> COOLING UNIT AVAILABLE

### STANDARD CABINET COLOUR



Black



G-Drink DM 9  
Vertical

## G-Drink DM

# Drink Evolution

### THE BEST FEATURES

An evolutionally machine to upgrade the G-Drink DY with the same software and technical features of DESIGN line.

Sanden Japanese cutting edge technology realized the supreme drink catcher of the **G-Drink** series creating a simple user friendly operation for the end user.

A spacious and brightly illuminated showcase enhances the product visibility.

New user friendly features offer a large display in blue characters with a new easy door latching system.





MODEL	G-DRINK DM VERTICAL DM 9	G-DRINK DM VERTICAL DM 6
DIMENSIONS H x W x D (mm)	1830* x 1215 x 845	1830* x 940 x 845
WEIGHT (NET - Standard machine without options)	345 kg	295 kg
NO. OF SELECTIONS PER SHELF	9	6
NO. OF SHELVES	Standard 5 / Max. 7	Standard 5 / Max. 7
NO. OF SELECTIONS	Standard 45 / Max. 63	Standard 30 / Max. 42
MAX. CAPACITY (0,33 l CANS)	504	336
MAX. CAPACITY (0,50 l PET BOTTLES)	360	240
PROTOCOL	Executive / MDB	Executive / MDB
COOLING SYSTEM CONTROL	Electronic	Electronic
INTERNAL TEMPERATURE RANGE	+2°C up to +10°C	+2°C up to +10°C
MAX. POWER CONSUMPTION	800 W	800 W
POWER SUPPLY	230 V / 50 Hz	230 V / 50 Hz
CLIMATE CLASS	ST (+16°C up to +38°C)	ST (+16°C up to +38°C)
ENERGY CONSUMPTION **	238 wh/h	252 wh/h
ENERGY CLASS **	A++	A

\* With adjustable leveling screw \*\* According to EVA EMP 3.0 - Data available upon request

### OPTION LIST

- ▶ CUSTOMIZED CABINET COLOUR
- ▶ SPECIAL CODED LOCK (RIELDA)
- ▶ ANTI-VANDALISM KEY PAD AND SAFETY COIN INSERT
- ▶ WALL/FLOOR FIXING KIT
- ▶ BRANDING
- ▶ PRODUCT SPACERS
- ▶ VARIOUS FITTING KITS
- ▶ LOCK PROTECTION
- ▶ FRONT GLASS PROTECTION
- ▶ CO<sub>2</sub> COOLING UNIT AVAILABLE

### VENDABLE PRODUCT SIZE

▶ PET BOTTLES, GLASS BOTTLES, CANS		
DIAMETER	min. 43.5 mm	max. 71.5 mm
HEIGHT	min. 88 mm	max. 266 mm
WEIGHT	min. 185 g	max. 653 g
▶ CARTON PACKS (BRICK)		
WIDTH	min. 52 mm	max. 67 mm
DEPTH	min. 40 mm	max. 47 mm
HEIGHT	min. 85 mm	max. 134 mm
WEIGHT	min. 213 g	max. 400 g

Please note: The above dimensions are for reference only. Some products, although within the above dimensions, may be difficult to vend due to its shape. Please vend test products before filling machine.

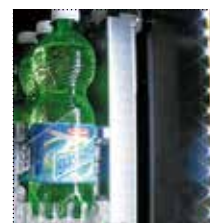

LED LIGHT



LED illumination as standard. Cold tone with an ideal brightness to boost the product display.

### STANDARD CABINET COLOURS



Black

Dark Gray

Light Gray

White



— DM Outdoor —



G-Drink DM 9  
Vertical Outdoor

## G-Drink DM Outdoor

# Outdoor Refreshment

TAKE YOUR BUSINESS OUTDOORS

High reliability is achieved through extreme simplicity in use and maintenance. Now SandenVendo offers OUTDOOR versions of the most popular model **G-Drink**. Weather resistance and anti-vandalism fittings can expand your business to OUTDOOR locations!



MODEL	G-DRINK DM VERTICAL OUTDOOR DM 9 OD	G-DRINK DM VERTICAL OUTDOOR DM 6 OD
DIMENSIONS H x W x D (mm)	1875* x 1260 x 1010	1875* x 990 x 1010
WEIGHT (NET - Standard machine without options)	410 kg	350 kg
NO. OF SELECTIONS PER SHELF	9	6
NO. OF SHELVES	Standard 5 / Max. 7	Standard 5 / Max. 7
NO. OF SELECTIONS	Standard 45 / Max. 63	Standard 30 / Max. 42
MAX. CAPACITY (0,33 l CANS)	504	336
MAX. CAPACITY (0,50 l PET BOTTLES)	360	240
PROTOCOL	Executive / MDB	Executive / MDB
COOLING SYSTEM CONTROL	Electronic	Electronic
INTERNAL TEMPERATURE RANGE	+2°C up to +10°C	+2°C up to +10°C
AMBIENT TEMPERATURE RANGE	-15°C up to +32°C	-15°C up to +32°C
MAX. POWER CONSUMPTION	800 W	800 W
POWER SUPPLY	230 V / 50 Hz	230 V / 50 Hz

\* With adjustable leveling screw



### OUTDOOR FEATURES

- ▶ FRONT GLASS PROTECTION
- ▶ ROOF
- ▶ THERMAL MAGNETIC CIRCUIT BREAKER
- ▶ TEMPERATURE CONTROLLER FOR OUTDOOR
- ▶ COOLING UNIT WITH HEATER ANTI-FREEZE FUNCTION (WORKS ALSO OUTSIDE TEMPERATURE BELOW ZERO)
- ▶ WATERPROOF IP34
- ▶ ANTI-VANDALISM (COIN INSERT, KEY PAD AND COIN-RETURN)
- ▶ LOCK PROTECTION
- ▶ HEATED GLASS ANTI-CONDENSATION
- ▶ AN EXCELLENT LED ILLUMINATION ALSO IN DARK



### VENDABLE PRODUCT SIZE

#### ▶ PET BOTTLES, GLASS BOTTLES, CANS

DIAMETER	min. 43.5 mm	max. 71.5 mm
HEIGHT	min. 88 mm	max. 266 mm
WEIGHT	min. 185 g	max. 653 g

#### ▶ CARTON PACKS (BRICK)

WIDTH	min. 52 mm	max. 67 mm
DEPTH	min. 40 mm	max. 47 mm
HEIGHT	min. 85 mm	max. 134 mm
WEIGHT	min. 213 g	max. 400 g

Please note: The above dimensions are for reference only. Some products, although within the above dimensions, may be difficult to vend due to its shape. Please vend test products before filling machine.



### OPTION LIST

- ▶ CUSTOMIZED CABINET COLOUR
- ▶ SPECIAL CODED LOCK (RIELDA)
- ▶ BRANDING
- ▶ PRODUCT SPACERS
- ▶ VARIOUS FITTING KITS
- ▶ WALL / FLOOR FIXING KIT
- ▶ LOCK PROTECTION
- ▶ CO<sub>2</sub> COOLING UNIT AVAILABLE

### STANDARD CABINET COLOURS





— Design Line —



G-Snack XL Master

## G-Snack Design

# Snacking, Solved!

THE COMPLETE SOLUTION

An evolutionary snack machine presented with a new look.

A spacious and brightly illuminated showcase enhances the product display.

An innovative capacitive key pad with back lit numerals provide high visibility in light and dark places. New user friendly features offer a large display in blue characters with a new easy door latching system. New software features of shelf detection and secure vending system make the machine complete.

Slave versions are now available to operate with G-Caffè, G-Drink DESIGN as well as G-Snack DESIGN and extends further versatile utility.







MODEL	G-SNACK DESIGN XL MASTER SDX	G-SNACK DESIGN XL SLAVE SSX	G-SNACK DESIGN 8 MASTER SC 8	G-SNACK DESIGN 8 SLAVE SS 8	G-SNACK DESIGN 6 MASTER SC 6	G-SNACK DESIGN 6 SLAVE SS 6
DIMENSIONS H x W x D (mm)	1830* x 1125 x 845	1830 x 980 x 845	1830* x 980 x 845	1830 x 830 x 845	1830* x 830 x 845	1830 x 685 x 845
WEIGHT (NET - Standard machine without options)	340 kg	290 kg	310 kg	240 kg	275 kg	220 kg
NO. OF SELECTIONS PER SHELF	10		8		6	
NO. OF SHELVES	Standard 6 / Max. 7		Standard 6 / Max. 7		Standard 6 / Max. 7	
NO. OF SELECTIONS	Max. 70		Max. 56		Max. 42	
PROTOCOL	Executive / MDB		Executive / MDB		Executive / MDB	
COOLING SYSTEM CONTROL	Electronic		Electronic		Electronic	
INTERNAL TEMPERATURE RANGE	+2°C up to +18°C		+2°C up to +18°C		+2°C up to +18°C	
MAX. POWER CONSUMPTION	600 W		600 W		550 W	
POWER SUPPLY	230 V / 50 Hz		230 V / 50 Hz		230 V / 50 Hz	
CLIMATE CLASS	ST (+16°C up to +38°C)		ST (+16°C up to +38°C)		ST (+16°C up to +38°C)	
ENERGY CONSUMPTION **	244 wh/h	234 wh/h	203 wh/h	193 wh/h	200 wh/h	190 wh/h
ENERGY CLASS **	A+		A+		A+	

\* With adjustable feet \*\* According to EVA EMP 3.0 - Data available upon request



### OPTION LIST

- ▶ SPEEDY LIFT
- ▶ DUO SYNCHRO SPIRAL **NEW**
- ▶ DOUBLE SPIRAL MOTOR
- ▶ DUO DIVIDER
- ▶ WALL / FLOOR FIXING KIT
- ▶ FRONT GLASS PROTECTION
- ▶ LOCK PROTECTION
- ▶ 7TH SHELF
- ▶ SPECIAL CODED LOCK (RIELDA)
- ▶ KIT SANDWICH / BAGUETTE
- ▶ BRANDING
- ▶ CUSTOMIZED CABINET COLOUR
- ▶ CO<sub>2</sub> COOLING UNIT AVAILABLE

### STANDARD CABINET COLOUR



Black



#### DUO SYNCHRO SPIRAL

An innovative system with a double motor drive that rotates perfectly synchronized in distance. Ideal for wide and bulky products.



#### SPEEDY LIFT

Delicate and/or fragile products can be sold at eye-height position! Speedy delivery of the products is guaranteed!



Complete "Design line"



— Design Outdoor —



G-Snack Design  
XL Master  
Outdoor

## G-Snack Design Outdoor

# Outdoor snacking

TAKE YOUR BUSINESS OUTDOORS

Europe's most successful snack machine with its stunning technical features and versatile functions is now available in an OUTDOOR version to extend your business beyond boundaries.

The unit is weather resistant and vandalism proof; it assures safety and security for your business in all OUTDOOR locations.



MODEL	G-SNACK DESIGN XL MASTER OUTDOOR <b>SDX OD</b>	G-SNACK DESIGN 8 MASTER OUTDOOR <b>SC 8 OD</b>	G-SNACK DESIGN 6 MASTER OUTDOOR <b>SC 6 OD</b>
DIMENSIONS H x W x D (mm)	1875 x 1200 x 1010	1875 x 1030 x 1010	1875 x 890 x 1010
WEIGHT (NET - Standard machine without options)	400 kg	350 kg	325 kg
NO. OF SELECTIONS PER SHELF	10	8	6
NO. OF SHELVES	Standard 6 / Max. 7	Standard 6 / Max. 7	Standard 6 / Max. 7
NO. OF SELECTIONS	Max. 70	Max. 56	Max. 42
PROTOCOL	Executive / MDB	Executive / MDB	Executive / MDB
COOLING SYSTEM CONTROL	Electronic	Electronic	Electronic
INTERNAL TEMPERATURE RANGE	+2°C up to +18°C	+2°C up to +18°C	+2°C up to +18°C
AMBIENT TEMPERATURE RANGE	-15°C up to +32°C	-15°C up to +32°C	-15°C up to +32°C
MAX. POWER CONSUMPTION	650 W	650 W	600 W
POWER SUPPLY	230 V / 50 Hz	230 V / 50 Hz	230 V / 50 Hz



### OUTDOOR FEATURES

- ▶ FRONT GLASS PROTECTION
- ▶ ROOF
- ▶ THERMAL MAGNETIC CIRCUIT BREAKER
- ▶ TEMPERATURE CONTROLLER FOR OUTDOOR
- ▶ COOLING UNIT WITH HEATER ANTI-FREEZE FUNCTION (WORKS ALSO OUTSIDE TEMPERATURE BELOW ZERO)
- ▶ WATERPROOF IP34
- ▶ ANTI-VANDALISM (COIN INSERT, KEY PAD AND COIN-RETURN)
- ▶ HEATED GLASS ANTI-CONDENSATION
- ▶ AN EXCELLENT LED ILLUMINATION ALSO IN DARK



### OPTION LIST

- ▶ SPEEDY LIFT
- ▶ DUO SYNCHRO SPIRAL
- ▶ DOUBLE SPIRAL MOTOR
- ▶ DUO DIVIDER
- ▶ KIT SANDWITCH / BAGUETTE
- ▶ 7TH SHELF
- ▶ CUSTOMIZED CABINET & DOOR COLOUR
- ▶ SPECIAL CODED LOCK (RIELDA)
- ▶ BRANDING
- ▶ VARIOUS FITTING KITS
- ▶ WALL / FLOOR FIXING KIT
- ▶ LOCK PROTECTION

### STANDARD CABINET COLOUR



Black



**SPEEDY LIFT**  
Delicate and/or fragile products can be sold at eye-height position!  
Speedy delivery of the products is guaranteed!



G-Snack SM 8

## G-Snack SM

# Snacking Simplicity

### THE BEST FEATURES

An evolutionary machine to upgrade the G-Snack PLUS with the same software and technical features of DESIGN line.

A spacious and brightly illuminated showcase enhances the product display.

User-friendly features offer a large display in blue characters with an easy door latching system.

Slave versions are now available to operate with G-Caffè, G-Drink DESIGN as well as G-Snack DESIGN and extends further versatile utility.



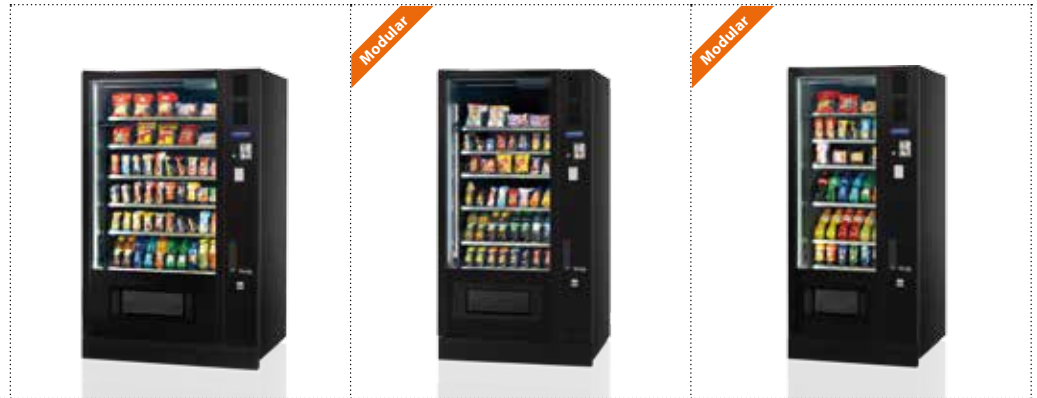

MODEL	G-SNACK SM MASTER *** SM X	G-SNACK SM MASTER *** SM 8	G-SNACK SM MASTER *** SM 6
DIMENSIONS H x W x D (mm)	1830* x 1125 x 845	1830* x 980 x 845	1830* x 830 x 845
WEIGHT (NET - Standard machine without options)	340 kg	310 kg	275 kg
NO. OF SELECTIONS PER SHELF	10	8	6
NO. OF SHELVES	Standard 6 / Max. 7	Standard 6 / Max. 7	Standard 6 / Max. 7
NO. OF SELECTIONS	Max. 70	Max. 56	Max. 42
PROTOCOL	Executive / MDB	Executive / MDB	Executive / MDB
COOLING SYSTEM CONTROL	Electronic	Electronic	Electronic
INTERNAL TEMPERATURE RANGE	+2°C up to +18°C	+2°C up to +18°C	+2°C up to +18°C
MAX. POWER CONSUMPTION	600 W	600 W	550 W
POWER SUPPLY	230 V / 50 Hz	230 V / 50 Hz	230 V / 50 Hz
CLIMATE CLASS	ST (+16°C up to +38°C)	ST (+16°C up to +38°C)	ST (+16°C up to +38°C)
ENERGY CONSUMPTION **	244 wh/h	203 wh/h	200 wh/h
ENERGY CLASS **	A+	A+	A+

\* With adjustable feet \*\* According to EVA EMP 3.0 - Data available upon request

\*\*\* Slave version available



### OPTION LIST

- ▶ SPEEDY LIFT
- ▶ DUO SYNCHRO SPIRAL **NEW**
- ▶ DOUBLE SPIRAL MOTOR
- ▶ DUO DIVIDER
- ▶ WALL / FLOOR FIXING KIT
- ▶ FRONT GLASS PROTECTION
- ▶ LOCK PROTECTION
- ▶ 7TH SHELF
- ▶ SPECIAL CODED LOCK (RIELDA)
- ▶ KIT SANDWICH / BAGUETTE
- ▶ BRANDING
- ▶ CUSTOMIZED CABINET COLOUR
- ▶ CO<sub>2</sub> COOLING UNIT AVAILABLE

### STANDARD CABINET COLOURS



**DUO SYNCHRO SPIRAL**  
An innovative system with a double motor drive that rotates spirals perfectly synchronized.  
Ideal for wide and bulky products.



**SPEEDY LIFT**  
Delicate and/or fragile products can be sold at eye-height position!  
Speedy delivery of the products is guaranteed!



**SAFETY HEALTH CONTROL**  
When the temperature stays over the set temperature for more than 30 min. sales will be prohibited. A Safety temperature can be programmed for individual shelves in the lower machine section.

**LIGHT CONTROL FOR ENERGY SAVING**  
Lights can be turned off at programmable periods.  
(Individual Start and Stop times can be programmed per day or for all days of the week. Also programmable to switch off lights "during vend-inhibited periods".)



— SM Outdoor —



G-Snack SM 8 OUTDOOR

## G-Snack SM Outdoor

# Outdoor snacking

TAKE YOUR BUSINESS OUTDOORS

Europe's most successful snack machine with its stunning technical features and versatile functions is now available in an OUTDOOR version to extend your business beyond boundaries.

The unit is weather resistant and vandalism proof; it assures safety and security for your business in all OUTDOOR locations.



MODEL	G-SNACK SM OUTDOOR SM X OD	G-SNACK SM OUTDOOR SM 8 OD	G-SNACK SM OUTDOOR SM 6 OD
DIMENSIONS H x W x D (mm)	1875 x 1200 x 1010	1875 x 1030 x 1010	1875 x 890 x 1010
WEIGHT (NET - Standard machine without options)	400 kg	350 kg	325 kg
NO. OF SELECTIONS PER SHELF	10	8	6
NO. OF SHELVES	Standard 6 / Max. 7	Standard 6 / Max. 7	Standard 6 / Max. 7
NO. OF SELECTIONS	Max. 70	Max. 56	Max. 42
PROTOCOL	Executive / MDB	Executive / MDB	Executive / MDB
COOLING SYSTEM CONTROL	Electronic	Electronic	Electronic
INTERNAL TEMPERATURE RANGE	+2°C up to +18°C	+2°C up to +18°C	+2°C up to +18°C
AMBIENT TEMPERATURE RANGE	-15°C up to +32°C	-15°C up to +32°C	-15°C up to +32°C
MAX. POWER CONSUMPTION	650 W	650 W	600 W



### OUTDOOR FEATURES

- ▶ FRONT GLASS PROTECTION
- ▶ ROOF
- ▶ THERMAL MAGNETIC CIRCUIT BREAKER
- ▶ TEMPERATURE CONTROLLER FOR OUTDOOR
- ▶ COOLING UNIT WITH HEATER ANTI-FREEZE FUNCTION (WORKS ALSO OUTSIDE TEMPERATURE BELOW ZERO)
- ▶ WATERPROOF IP34
- ▶ ANTI-VANDALISM (COIN INSERT, KEY PAD AND COIN-RETURN)
- ▶ LOCK PROTECTION
- ▶ HEATED GLASS ANTI-CONDENSATION
- ▶ AN EXCELLENT LED ILLUMINATION ALSO IN DARK



### OPTION LIST

- ▶ SPEEDY LIFT
- ▶ DUO SYNCHRO SPIRAL
- ▶ DOUBLE SPIRAL MOTOR
- ▶ DUO DIVIDER
- ▶ KIT SANDWICH / BAGUETTE
- ▶ 7TH SHELF
- ▶ CUSTOMIZED CABINET & DOOR COLOUR
- ▶ SPECIAL CODED LOCK (RIELDA)
- ▶ BRANDING
- ▶ VARIOUS FITTING KITS
- ▶ WALL / FLOOR FIXING KIT

### STANDARD CABINET COLOURS



Black

Dark Gray

Light Gray

White



**SPEEDY LIFT**  
Delicate and/or fragile products can be sold at eye-height position!  
Speedy delivery of the products is guaranteed!



— Budget —



G-Snack Budget Master 8

G-Snack Budget

# Quality beyond Budget

NOT SO BUDGET AFTER ALL!

SandenVendo presents the incredible **NEW BUDGET** Snack machine.

High quality, great features and easy to use. All at a low price.

A pre cooling area allows products to be stored at ready-to-sell temperatures. A large LCD display, LED illumination and Energy saving program settings are all fitted as standard.





MODEL	G-SNACK BUDGET MASTER 8 BS 8
DIMENSIONS H x W x D (mm)	1830 x 875 x 780
WEIGHT (NET - Standard machine without options)	250 kg
NO. OF SELECTIONS PER SHELF	8
NO. OF SHELVES	Standard 6 / Max. 7
NO. OF SELECTIONS	Max. 56
PROTOCOL	Executive / MDB
COOLING SYSTEM CONTROL	Electronic
INTERNAL TEMPERATURE RANGE	+8°C up to +18°C
MAX. POWER CONSUMPTION	400 W
POWER SUPPLY	230 V / 50 Hz
CLIMATE CLASS	ST (+16°C up to +38°C)
ENERGY CONSUMPTION **	126 wh/h
ENERGY CLASS **	A++

\*\* According to EVA EMP 3.0 - Data available upon request



### OPTION LIST

- ▶ OPTICAL SENSOR FOR PRODUCT DETECTION
- ▶ DUO SYNCHRO SPIRAL **NEW**
- ▶ DOUBLE SPIRAL MOTOR
- ▶ DUO DIVIDER
- ▶ ROOF KIT
- ▶ ANTI-VANDALISM KEY PAD AND SAFETY COIN INSERT
- ▶ FRONT GLASS PROTECTION
- ▶ WALL / FLOOR FIXING KIT
- ▶ SPECIAL CODED LOCK (RIELDA)
- ▶ FOOT COVER PANEL
- ▶ 7TH SHELF
- ▶ BRANDING
- ▶ CUSTOMIZED CABINET & DOOR COLOUR

### STANDARD CABINET COLOURS



Products can be stored in pre-cooling area



- 1. DOUBLE CUT OUT**  
*Ready for Cashless and Bill-validator installation*
- 2. DISPLAY**  
*Easy to read, well illuminated character*
- 3. COIN INSERT**  
*Standard Slot or Safety slide coin insert as option (easy to change)*
- 4. KEY PAD**  
*Telephonic Key pad in plastic or Metal anti-vandalism as option*
- 5. FLAP COIN RETURN**  
*A simple flap opening with anti-theft system*
- 6. REMOVABLE COOLING UNIT AND LOWER GRID**  
*Easy removing lower liner and grid to access and cleaning of Cooling unit*
- 7. DOUBLE PANE GLASS**
- 8. LED ILLUMINATION**  
*LED as standard, illumination from top inner cell*
- 9. POP-OUT LEVER OPENING**  
*Easy and smooth door opening with a pop-out lever*
- 10. CABINET**  
*A fully insulated cabinet, foamed with Eco compatible components.*
- 11. PRODUCT STORAGE AREA**  
*Products can be stored in pre-cooling area*



G-Snack Combi 585

## G-Snack Combi

# Value for space!

### FLEXIBILITY GUARANTEED

Designed and built to penetrate new markets and locations where footprint is limited but high product capacities and a wide range of selections are required.

This Combi vendor, with its product spirals and 6 shelves, easily adjustable to product size, supports sales of cold drinks (bottle/can), snacks and confectionery "to go".

Design and technical specifications have been established in accordance with safety regulations and state-of-the-art technology.

MODEL	COMBI SVE 585
DIMENSIONS H x W x D (mm)	1830* x 850 x 900
WEIGHT (NET - Standard machine without options)	340 kg
NO. OF SHELVES (SNACK AREA)	Max. 6
NO. OF SELECTIONS PER SNACK SHELF	4
NO. OF COLD DRINK COLUMNS	4
NO. OF SELECTIONS (SNACK AND DRINKS)	Max. 28
MAX. CAPACITY (0,33 l CANS)	272
MAX. CAPACITY (0,50 l PET BOTTLES)	136
PROTOCOL	Executive / MDB
COOLING SYSTEM CONTROL	Electronic
INTERNAL TEMPERATURE RANGE	+4°C up to +25°C
MAX. POWER CONSUMPTION	650 W
POWER SUPPLY	230 V / 50 Hz
CLIMATE CLASS	ST (+16°C up to +38°C)

\* With adjustable leveling screw



### OPTION LIST

- ▶ DUO SYNCHRO SPIRAL **NEW**
- ▶ DOUBLE SPIRAL MOTOR
- ▶ DUO DIVIDER
- ▶ ROOF KIT
- ▶ ANTI-VANDALISM KEY PAD AND SAFETY COIN INSERT
- ▶ FRONT GLASS PROTECTION
- ▶ LOCK PROTECTION KIT
- ▶ WALL / FLOOR FIXING KIT
- ▶ SPECIAL CODED LOCK (RIELDA)
- ▶ FOOT COVER PANEL
- ▶ KIT SANDWICH / BAGUETTE
- ▶ BRANDING
- ▶ CUSTOMIZED CABINET & DOOR COLOUR

### STANDARD CABINET COLOURS



#### 1. CABINET

A fully insulated cabinet, foamed with Eco compatible components.

#### 2. NARROWSTACK COLUMN

High capacity for bottles and cans.

#### 3. DISPLAY

Easy to read, well illumined characters.

#### 4. TEMPERATURE CONTROL

Individual programmable temperatures for cold drink and snack compartment electronically controlled.

#### 5. COOLING UNIT

Low energy consumption and high performance. The cooling unit is removable.

#### 6. MOTORIZED ANTI-THEFT DEVICE

Prevents from access to the internal cabinet.

#### 7. ANTI-VANDALISM OPTION

Anti-vandalism solution with Solid metal key pad and a metal Safety slide coin insert.

#### 8. SAFETY COIN RETURN

Drum typed Coin return, anti-vandalism solution.

#### 9. DOUBLE TEMPERED GLASS

Large glass showcase display to maximize impulse sales.

#### 11. LED ILLUMINATION

LED as standard. Cold tone with an ideal brightness to boost the product display.

#### 12. DOOR

A solid structure with T-handle opening.



The background of the entire page is a photograph of a city skyline, likely New York City, viewed from a distance. The skyline is composed of various high-rise buildings of different architectural styles. In the foreground, there is a dense forest of trees with vibrant autumn foliage in shades of yellow, orange, and red. Below the trees, a large body of water, possibly a lake or reservoir, is visible, reflecting the sky and the surrounding landscape. The sky is a clear, bright blue with a few small, white clouds.

# We contribute to the future of a safer and more beautiful earth.

Based on the Environmental Chapter of Sanden Corporation, we fully understand that preserving the Earth's environment is the most important shared responsibility of mankind.

In order to pass on a safe and clean Earth to the next generation, we, all staff members, will take the appropriate steps in all areas of business activities to preserve the environment with our company slogan:

*"We contribute to the future of a safer and more beautiful Earth."*

**Heaven, Earth** and **Man**, are the three fundamental elements that create the Universe and therefore, we should keep the harmony among those elements which reflect on our everyday life.

This is the foundation of the SandenVendo ECO Philosophy.



We will keep and conserve them also in the future by protecting them as much as possible.

## ECO Project

It is our mission to study environmentally friendly product developments.

We strongly believe that the improvement of our vending machines should contribute to the reduction of their environmental impact.

Our activities are lead by our mother company Sanden Corporation in Japan, one of the leaders in the research & development of the environmentally friendly products in this field.

### EVA EMP ENERGY CLASS A+

Already achieved on new models G-Drink and G-Snack and will extend to all models

### LED ILLUMINATED PRODUCTS AS STANDARD

All glass front machines are fitted with LED illumination since 2009. Application on other models in progress

### ENERGY EFFICIENT COOLING UNIT

New models are fitted with less energy consuming Cooling units

### CO<sub>2</sub> COOLING UNIT

An alternative cooling unit with CO<sub>2</sub> that has less impact on the environment.

We have been supplying our machines with CO<sub>2</sub> Cooling units for Olympic games since 2004

### COOLING UNIT WITH CFC FREE REFRIGERANT

Our standard machines are supplied with R134a & R404A - CFC Free

### CABINETS

ARE INSULATED WITH ECOLOGICAL POLYURETHANE

### ENERGY SAVING PROGRAM

Light control mode with real time clock etc

### ECO FACTORY PROJECT

- Replacement to low energy consuming light achieved energy saving of 30%
- S-TQM\* (Sanden Total Quality Management) activity to reduce metal and energy waste
- Waste water from Painting is purified which allows recycling
- Different collection of garbage with waste

\* please visit our web-site: [www.sandenvendo.com](http://www.sandenvendo.com)

---

## ECO Initiative

ECO VENDO PROJECT it is our NEW initiative to communicate our ECO achievements of producing the energy efficient products to the consumers through our vending machines.

It is our eternal commitment to provide high quality and ECO compatible products to our clients and to the end users.

---

### EVA EMP (Energy Measurement Protocol)

Has an original table of classification: The higher A++ and the lower G class, similar to the European directive of White goods. The test is carried out in our Lab, according to this protocol and regulations, depending on the product classification. The data is available upon the client's request.



Sanden, in partnership with nature

# Why CO<sub>2</sub>?

## Cooling unit with ECO gas

Go GREEN with SandenVendo new environmentally-friendly CO<sub>2</sub> Cooling Unit.  
Eco gas Carbon dioxide (R744) refrigerant is more efficient than the industry standard R-134a refrigerant.

**NON-TOXIC | NON-FLAMMABLE | NON-OZONE DEPLETING**

Sanden group has been the supplier of CO<sub>2</sub> cooling units for all Olympic games since 2004.  
Advanced technology and our severe test procedure guarantees quality and performance of CO<sub>2</sub> refrigerant system.

- » **CO<sub>2</sub> is a Natural gas that "EXISTS IN THE EARTH & NEEDS TO BE REDUCED"**
- » **CO<sub>2</sub> purifies through the natural botanical cycle known as photosynthesis**
- » **High efficiency System in terms of lifetime cost, Running / Disposal / Repair**
- » **REDUCES RISK OF GLOBAL WARMING (GWP = 1)**
- » **LED ILLUMINATION**



**Join our ECO Project and do your part to save the environment!**

**B & C**

— SuperStack —



B&C Superstack 217-6

SuperStack

# All Day, Every Day

THE SANDENVENDO COLD DRINKS VENDING MACHINES

- Each column has an individual vend motor
- Thermostatically controlled forced air-cooling
- Product pre-cooling
- Foamed cabinet
- Anti-theft device
- Interchangeable parts





MODEL	SUPERSTACK SVE 100-5	SUPERSTACK SVE 189-5	SUPERSTACK SVE 217-6	SUPERSTACK SVE 254-7
DIMENSIONS H x W x D (mm)	1425 x 705 x 745	1830 x 705 x 745	1830 x 855 x 745	1830 x 1010 x 745
WEIGHT (NET - Standard machine without options)	185 kg	235 kg	265 kg	295 kg
NO. OF SELECTIONS / COLUMNS	5 / 5	5 / 5	6 / 6	7 / 7
MAX. PRODUCT LENGTH (mm)	300	300	300	300
MAX. PRODUCT DIAMETER (mm)	66	66	66	68,5
PROTOCOL	Executive / MDB	Executive / MDB	Executive / MDB	Executive / MDB
COOLING SYSTEM CONTROL	Thermostat	Thermostat	Thermostat	Thermostat
REFRIGERATION POWER	806 W / 7,7 cc	806 W / 7,7 cc	803 W / 8,8 cc	803 W / 8,8 cc
INTERNAL TEMPERATURE RANGE	+2°C up to +10°C	+2°C up to +10°C	+2°C up to +10°C	+2°C up to +10°C
MAX. POWER CONSUMPTION	500 W	500 W	600 W	600 W
POWER SUPPLY	230 V / 50 Hz	230 V / 50 Hz	230 V / 50 Hz	230 V / 50 Hz

CAPACITIES				
CAN 0,33 l	190	300	360	434
PET BOTTLE 0,50 l	95	150	180	224
GLASS RETURNABLE BOTTLE 0,20 l	100	175	210	245
GLASS RETURNABLE BOTTLE 0,33 l	95	150	180	231
GLASS NON RETURNABLE BOTTLE 0,33 l	95	150	180	231
GLASS RETURNABLE BOTTLE 0,50 l	-	-	-	210

N.B. Capacities will vary based on the shape and dimension of the product.



#### OPTION LIST

- ▶ CUSTOMIZED CABINET & DOOR COLOUR
- ▶ TWO-LINE LCD DISPLAY
- ▶ SECURITY CASH SYSTEMS
- ▶ SAFETY COIN INSERT
- ▶ WALL / FLOOR FIXING KIT
- ▶ SPECIAL CODED LOCK (RIELDA)
- ▶ BRANDING

#### STANDARD CABINET COLOURS



**B & C**

— *NarrowStack* —



*B&C NarrowStack Basic*

NarrowStack

# Ready to serve 24 hours a day

THE SANDENVENDO COLD DRINKS VENDING MACHINES

- Easy programming using selection button sequence
- Electronic control and data-recording
- Energy Management by real time clock
- Each column driven via individual vend motor
- 24 V DC motors
- Interchangeable parts
- Quadruple loading for 0.33 l cans and double loading for 0.50 l PET bottles up to 245 mm height

NarrowStack BASIC offers NarrowStack technology at competitive price. **A great value for price and quality!**



MODEL	NARROWSTACK BASIC SVE 480-7 DD	NARROWSTACK BASIC SVE 550-8 DD	NARROWSTACK SVE 680-10 DD
DIMENSIONS H x W x D (mm)	1830 x 750 x 940	1830 x 850 x 940	1830 x 1010 x 940
WEIGHT (NET - Standard machine without options)	310 kg	335 kg	390 kg
NO. OF SELECTIONS / COLUMNS	7 / 7	8 / 8	10 / 10
MAX. PRODUCT LENGTH (mm)	505	505	505
MAX. PRODUCT DIAMETER (mm)	72	72	72
PROTOCOL	Executive / MDB	Executive / MDB	Executive / MDB
COOLING SYSTEM CONTROL	Thermostat	Thermostat	Electronic
REFRIGERATION POWER	520 W / 10 cc	520 W / 10 cc	997 W / 14 cc
INTERNAL TEMPERATURE RANGE	+2°C up to +10°C	+2°C up to +10°C	+2°C up to +10°C
MAX. POWER CONSUMPTION	580 W	580 W	800 W
POWER SUPPLY	230 V / 50 Hz	230 V / 50 Hz	230 V / 50 Hz
<b>CAPACITIES</b>			
CAN 0,33 l	476	544	680
PET BOTTLE 0,50 l	238	272	340



#### OPTION LIST

- ▶ CUSTOMIZED CABINET & DOOR COLOUR
- ▶ TWO-LINE LCD DISPLAY
- ▶ STACK ASSEMBLY FOR PRODUCT Ø 74 mm
- ▶ SECURITY CASH SYSTEMS
- ▶ LOADING RACK (ONLY FOR BASIC MODEL)
- ▶ SAFETY COIN INSERT
- ▶ WALL / FLOOR FIXING KIT
- ▶ SPECIAL CODED LOCK (RIELDA)
- ▶ WEATHER PROTECTION
- ▶ BRANDING

#### STANDARD CABINET COLOURS



**B & C**

— FlexStack —



B&C FlexStack 609

FlexStack

# Modern traditional

THE SANDENVENDO COLD DRINKS VENDING MACHINES

Maximum flexibility is created by its complete modular structure.

Different vend modules for individual requirements:

Your choice of narrow stack modules, adjustable wide stack modules and flapper modules for carton packs in combination.

MODEL	FLEXSTACK - SVE 609
DIMENSIONS H x W x D (mm)	1830 x 1010 x 815
WEIGHT (NET - Standard machine without options)	335 kg
NO. OF SELECTIONS	10
NO. OF MODULES	from 5 to 8
PROTOCOL	Executive / MDB
COOLING SYSTEM CONTROL	Electronic
REFRIGERATION POWER	899 W / 14 cc
INTERNAL TEMPERATURE RANGE	+2°C up to +10°C
MAX. POWER CONSUMPTION	700 W
POWER SUPPLY	230 V / 50 Hz

CAPACITIES: VENDABLE / PRE-COOL	WIDE STACK*	NARROW STACK**	FLAPPER MODULE
CAN 0,33 l	87 / 3 (3D)	51 / 3 (3D)	24 + 24
PET BOTTLE 0,50 l	29 / 1 (1D)	17 / 1 (1D)	-
PET BOTTLE 1,00 l	22-24 / 1 (1D)	-	-
PET BOTTLE 1,50 l	16-18 / 1 (1D)	-	-
CARTON PACK 0,25 l	-	-	40 + 40
CARTON PACK 0,33 l	-	-	28 + 28

\* WIDE STACK Product dimensions: Ø Min. 53 mm - Max. 96 mm, length 350 mm

\*\* NARROW STACK Product dimensions: Ø Min. 53mm - Max. 72 mm, length 368 mm

N.B. Capacities will vary based on the shape and dimension of the product.

**5 WIDE STACKS** x 1,50 l

**6 WIDE STACKS** x 1,00 l

**4 NARROW STACKS** FOR  
0,33 l CANS OR 0,50 l PET  
**3 WIDE STACKS** x 1,50 l

- Product diameters from 53 mm to 96 mm
- Combinative and convertible modules as you like
- High vend-mechanism reliability
- Easy and simple programming by using the direct selection buttons
- Easy convertible stacks (bottle to / from can)
- Double inner door (better insulation)
- Energy saving program
- Recommended for In-door use and Out-door kit available (option)
- Easy cleaning and maintenance for the cooling unit

1,50 l

1,00 l

1,50 l  
0,50 l  
0,33 l

**STANDARD CABINET COLOURS**

Black

Dark Gray

Light Gray

White

- ✓

OPTION LIST

  - ▶ CUSTOMIZED CABINET & DOOR COLOUR
  - ▶ TWO-LINE LCD DISPLAY
  - ▶ SECURITY CASH SYSTEMS
  - ▶ SAFETY SLIDE COIN INSERT
  - ▶ WALL / FLOOR FIXING KIT
  - ▶ SPECIAL CODED LOCK (RIELDA)
  - ▶ BRANDING
  - ▶ WEATHER PROTECTION



ICV 05

## ICV 05

# Vending machines for packaged ice creams

EVERY HOUR IS AN ICE CREAM HOUR

- Minimum thermal dispersion for product loading with a small internal door.
- A foldable table to place the cartons for easy and fast product loading.
- Ergonomic central delivery eyelet: Easy-to-reach also for wheel chair users and children.
- State of the Art cooling unit: Removable, high performance and high reliability.
- Independent cooling unit control for quick and easy operation.
- Easy accessible internal cell for maintenance. To remove a column takes only 3 min!

MODEL	ICV 05
DIMENSIONS H x W x D (mm)	1830 x 920 x 790
WEIGHT (NET - Standard machine without options)	305 kg
NO. OF SELECTIONS	4
NO. OF COLUMNS	4*
MAX. CAPACITY	204
PROTOCOL	Executive / MDB
COOLING SYSTEM CONTROL	Electronic
REFRIGERATION POWER	1000 W / 15,3 cc
INTERNAL TEMPERATURE RANGE	-18 °C up to -23 °C
CLIMATE CLASS	N (+16°C up to +32°C)
MAX. POWER CONSUMPTION	1100 W
POWER SUPPLY	230 V / 50 Hz

\* STANDARD: 3 columns for flat packages - 1 column for cones



### OPTION LIST

- ▶ CUSTOMIZED CABINET & DOOR COLOUR
- ▶ SECURITY CASH SYSTEMS
- ▶ SAFETY COIN INSERT
- ▶ WALL / FLOOR FIXING KIT
- ▶ SPECIAL CODED LOCK (RIELDA)
- ▶ BRANDING
- ▶ COLUMN COMBINATIONS
- ▶ PRODUCT MODULE FOR CONE ICE CREAMS

### STANDARD CABINET COLOURS



Dark Gray



White

### VENDABLE PRODUCT DIMENSIONS



#### CONVEYOR COLUMN FOR FLAT SHAPE PACKAGES

51 PCS. PER COLUMN

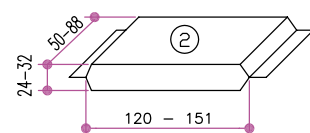
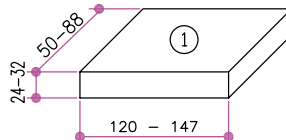

FLAT PACKAGES

#### CONVEYOR COLUMN FOR CONE SHAPE PACKAGES

39 PCS. PER COLUMN

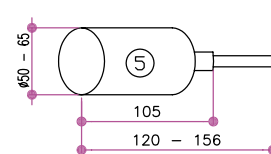
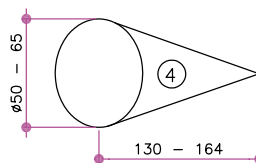

CONE PACKAGES

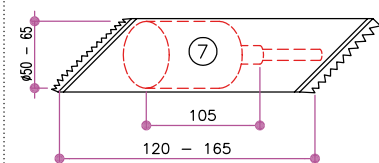
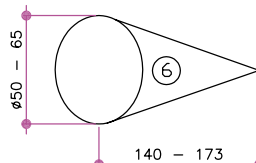

**SC5€**



COIN CHANGER SANDEN SC5 € 5 tubes  
**5 different versions to meet  
all your needs.**



## DUAL C

A coin changer with double protocol: Executive Master or MDB slave.

All the AUDIT EVA DTS data are available through Jack connector of coin changer or with a handy terminal (optional).

Change  
1 Euro

## DUAL D

A coin changer with multiprotocol, giving a possibility to connect with a vending machine in Executive and up to 2 payment system in MDB simultaneously, as well as with protocol MDB slave.

All the AUDIT EVA DTS data are available through Jack connector of coin changer or with a handy terminal (optional).

Change  
1 Euro

## MDB E

You can obtain as many as 24 different configuration in only one coin cassette, by using only 2 additional spacers (1 Euro and 20 cents). Ideal for the vending machine to retail expensive products and/or to use along with the bill validator. This model gives also 2€ as a change.

Change  
1 Euro / 2 Euro

## MDB D

A coin changer with MDB protocol: Coin cassette with an additional feature to give 1€ as a change.

Change  
1 Euro

## UNI A

A coin changer with MDB protocol designed for the Tobacco sector, parking etc. The system is protected against humidity. Stand-by function for energy saving. Automatic device to convert from 12V to 24V. A unique cassette with 12 different configurations.

Change  
1 Euro / 2 Euro

### TECHNICAL DATA

PROTOCOL	MDB / EXE
ACCEPTANCE	5c, 10c, 20c, 50c, 1€, 2€
TEMPERATURE RANGE	-15 °C up to +60 °C
MAX HUMIDITY	90%
POWER CONSUMPTION	Stand-by 2.7 W / max. 27.9 W
POWER SUPPLY	MDB version: 20,0 VDC up to 42,5 VDC / EXE version: 20,4 VAC up to 26,4 VAC
DIMENSIONS H x W x D (mm)	380 x 140 x 84
WEIGHT (NET - Standard machine without options)	1,8 kg

### COIN TUBE CAPACITY

COIN	QUANTITY
5c	86
10c	72
20c	65
50c	58
1€	59
2€ *	59

\* Only for MDB E and UNI A

NB The above quantities are indicative and it varies according to the coin-changer types.

### STANDARD

- » Easy and user-friendly programming and handling
- » Transparent cover for immediate diagnostics
- » DIL-switch board for fast and easy configuration
- » Individual tube level programming
- » Programming mode for 2 free vend tokens
- » Data retrieval and prophetic interfaces
- » Programming mode to reject false coins
- » Modular components
- » 5 tubes for high capacity
- » Anti-manipulation devices

### OPTIONAL

- » Conversion kit/spacer kit 10c for tube E & others
- » Palm top and accessories
- » Thermo-printer (DEX) for Dual A/C and B/D
- » Handy terminal for Dual A/C and B/D

© 2016 Sanden International (Europe) Ltd

All rights reserved.

Specification subject to change without notice.

Rev. 02 - May 2016





English 



**Sanden International (Europe) LTD**

SandenVendo German Branch

Tel **+49 (0) 211 74039 0**

e-mail [info@sandenvendo.de](mailto:info@sandenvendo.de)



**Sanden International (Europe) LTD**

SandenVendo Benelux

Tel **+32 2 268 2595**

e-mail [info@sandenvendo.be](mailto:info@sandenvendo.be)



**Sanden International (Europe) LTD**

SandenVendo Italian Branch

Tel **+39 0142 335 119**

e-mail [marketing@sandenvendo.it](mailto:marketing@sandenvendo.it)



**Sanden International (Europe) LTD**

SandenVendo Spain, Sucursal en Espana

Tel **+34 93 474 1555**

e-mail [info@sandenvendo.es](mailto:info@sandenvendo.es)



**Sanden International (Europe) LTD**

SandenVendo France

Tel **+33 1 70 38 24 88**

e-mail [info@sandenvendo.fr](mailto:info@sandenvendo.fr)

[www.sandenvendo.com](http://www.sandenvendo.com)

**Vendo**  
 **SANDEN**